

Balfit® SAE 37° Flared Pipe Fittings

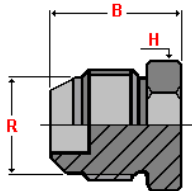

Balfit® Plugs – 35.140. / 35.141.

carbon steel plug



35.140. - JIC Plug

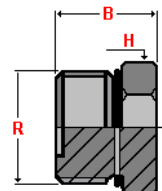

35.141. - Straight Thread Plug

According to **ISO 8434-2** According to **SAE J514**

Material: Carbon Steel
Finish: Zinc-plated

part number	∅ tube		thread	dimensions		working pressure bar
	mm	inch		B	H	
35.140.04	1/4"	7/16" - 20	20	13	345	
35.140.05	5/16"	1/2" - 20	20	14	345	
35.140.06	3/8"	9/16" - 18	21	16	345	
35.140.08	1/2"	3/4" - 16	24	19	310	
35.140.10	5/8"	7/8" - 14	28	24	240	
35.140.12	3/4"	1.1/16" - 12	33	27	240	
35.140.16	1"	1.5/16" - 12	34	36	210	
35.140.20	1.1/4"	1.5/8" - 12	37	46	170	
35.140.24	1.1/2"	1.7/8" - 12	42	50	140	
35.141.04	1/4"	7/16" - 20	17	14	345	
35.141.05	5/16"	1/2" - 20	17	16	345	
35.141.06	3/8"	9/16" - 18	19	18	345	
35.141.08	1/2"	3/4" - 16	20	22	310	
35.141.10	5/8"	7/8" - 14	24	25	240	
35.141.12	3/4"	1.1/16" - 12	28	32	240	
35.141.16	1"	1.5/16" - 12	29	38	210	

also available:

Balfit® Stainless Steel Plugs

(add an 'S' at the end of the part number; ex: 35.140.08 S or 35.141.06 S)

Construction characteristics and dimensions may be changed at any time without prior notice.

The data contained herein is information purposes only and does not enlarge, amend or imply any warranty other than provided by the manufacturer with the product. Any use of the product not in conformance with the manufacturer's instructions may be dangerous.

Only items in this catalogue are carried in stock. Some items are subjected to minimum quantities or sold only in multiples of standard quantities. Please refer to the price list or contact our commercial department.